

Super MD



Massage Chair User Manual







REBALANSE

- ✦ Please read this manual carefully to make sure the installation and operation of the massage chair is correct.
- ✦ “Safety Instructions” is provided in both Warning and Caution for important safety information.



Both Warning and Caution are important safety caution, please pay more attention.

	Warning	This sign indicates warning of causing possible death or hurt to body.
	Caution	This sign indicates caution of causing possible hurt or damage to things.

Symbol meaning

	This sign indicates forbidden behavior.		This sign indicates self disassembly is forbidden.
	This sign indicates must follow instruction to operate.		This sign indicates correct operation of cable.

- ✦ The following should be kept for any further references.

 Warning		
	<ul style="list-style-type: none"> ● People with osteoporosis, vertebral fractures, and acute painful diseases such as sprains or muscle strains. ● Heart disease patients (including those who have pacemakers or are using other medical electronics). ● Cancer patients. ● People with perceptual disorders due to high levels of peripheral circulatory disturbances such as diabetes. ● People with abnormal spine or crooked spine. ● People with Protruded intervertebral Disc. ● Pregnant women and those who have just completed childbirth, as well as people with poor health. ● People with trauma, such as thrombosis, acute varices, and various skin inflammations. ● People who have been identified as having lost their ability to discern temperature. ● People with high fever (acute inflammation: such as burnout, chills, blood pressure changes, physical weakness). ● Elderly people over 80. ● Persons with impaired consciousness, mentally handicapped persons, or those who are incapable of operating the unit are prohibited from using this unit. ● People who can not take care of themselves, infants, and drunkards. ● Do not use this unit when it is wet or when you are wet. ● It must be taken care of, or not used by people who are not sensitive to heat or people who are allergic to heat. ● Do not fall asleep in this unit. <p>People with above symptoms should not use massage chair, or use it under doctor's advice. User's discretion is advised if use the chair.</p>	<p>Not suitable users.</p> <p>Risk of causing accident or body discomfort.</p>



Warning

	<ul style="list-style-type: none"> ● Before sitting, please confirm that there are no foreign matter inclusions between the various parts of the machine. ● When using the backrest , calf up &down, or calf extend, be sure to check that there are no people or objects in the area (behind, under, or in front of the chair). ● In the event of a physical abnormality or abnormality in use, stop using it immediately and ask a doctor. ● Massage around the head should pay attention to the movement of the massage rollers, the head should not do too much or too strong massage. ● Pay special attention when you massage the area around your neck. ● Avoid excessive neck massage. ● Do not massage the abdomen or knees with this machine. ● If you want to leave your seat during the massage, you must stop the massage chair before you leave the seat. ● Do not use it with other instruments. ● Do not allow children or pets to play on or around the unit (especially in use); nor can they sit or stand on backrests ,armrests or legrest. ● When people are inconvenient for action or lack of communication skills, they must have strict and continuous care. ● Before moving the unit, the backrest and legrest must be angled back to their original position. 	<p>Accident/injury</p>
	<ul style="list-style-type: none"> ● When assembling, turn off the switch and unplug it after the chair returns. ● Insert the plug of the chair into correct and suitable power socket. Make sure the plug is completely inserted into the socket to reduce short circuit or fire risk. ● Unplug the power when not in use, stop all massage functions and turn off on/off key before unplugging. 	<p>Fire and electric shock</p>
	<ul style="list-style-type: none"> ● Massage cushions of the chair are not allowed to fold for storage. ● The machine is forbidden for no-load running for a long time. ● An appliance should never be left unattended when plugged in. 	<p>Accident</p>
	<ul style="list-style-type: none"> ● Power cord, plug, socket can't be used in broken or loose contact condition. ● Don't use other electric power except rated voltage in case of fire, electric shock or any breakdown. ● Any broken, re-process, knotted, twisted power cord or pressed under heavy cargo is not allowed to use. ● Never operate this appliance if it has a damaged cord or plug, if it is not working. ● Keep the cord away from the heated surfaces. 	<p>Fire and electric shock</p>
	<ul style="list-style-type: none"> ● If the chair works dysfunctional, or is broken, splashed with water or falls into water, please have it repaired by professional repairman or send the chair to assigned service agent. Self-modification, disassembly or maintenance is forbidden. ● If power cord or plug is damaged, please don't replace it yourself, please contact us or appointed dealer for replacement. ● To avoid electric shock or body hurt, please don't open or disassemble any part of the chair, there is not any attached part of the chair for maintenance by customers. ● Check leather or cloth material on the back and other areas is broken or not. If broken, even though it is small ,please stop using the chair, unplug the power and have it repaired 	<p>Disassembly and maintenance</p>



Caution

	<ul style="list-style-type: none"> ● Please operate the chair in a flat or level place. 	To avoid sudden falling.
	<ul style="list-style-type: none"> ● The maximum suggested operating time is 20mins. 5mins for each position beginning with the slight- step massage. Along continuous massage in the same position may cause uncomfortable feeling. 	Too long time massage is bad for your body.
	<ul style="list-style-type: none"> ● Before sitting on the chair to avoid injury please inspect everything to confirm that the massage heads are in the correct position. 	To avoid accidental injury.
	<ul style="list-style-type: none"> ● Hand control should be timely put into the hand control bag, do not arbitrarily put away, to avoid squeezing or drop damage. 	
	<ul style="list-style-type: none"> ● Please make sure that the power switch is at the “OFF” position before inserting the plug into the socket. 	
	<ul style="list-style-type: none"> ● Turn off all controls before removing plug from outlet. 	To avoid the accident when turn on the power.
	<ul style="list-style-type: none"> ● Make sure the plug completely insert into the socket. 	To reduce short circuits and any fire hazard.
	<ul style="list-style-type: none"> ● Checking whether any damage on wire, make sure no water or rubbish on wire. 	To avoid electric shock in any leakage or breakdown.
	<ul style="list-style-type: none"> ● Installing earth wire in correct way. The plug must be inserted into socket with earth connect, the earth connect couldn't be bend or cut off. 	
	<ul style="list-style-type: none"> ● Don't press with hands or step on the massage heads with feet. ● Don't put hands between the working massage heads. ● Don't put hands or feet in the gap of mechanical parts. ● Don't drop or embed anything into the slot of massage chair. ● Don't stand or sit or put anything on the backrest, armrest or leg-rest. ● Don't move the chair during operation. ● Don't stand on the chair during operation. ● Don't pull out the plug or turn off the power during operation. ● Don't put your hands or head between leg-rest or beneath. ● Don't use the massage chair while wearing hair ornaments. ● Don't put hard things in pocket when take buttocks and huckle massage. ● Don't sit or press on the backrest when the chair is in reclining position. ● Don't use at bare skin or were thin clothes, thin clothes may can achieve better massage effect, But it also may cause irritation to the skin or cryogenic burns. ● Do not use massager in close proximity to loose clothing or jewelry. Keep long hair away from massager while in use. 	To avoid accidents or injury
	<ul style="list-style-type: none"> ● Keep the chair away from heat, wet, sharp things and corrosive, inflammable, explosive environment. ● To use electric blanket or other heating products on the chair is forbidden. ● Keep the chair away from stove or other heating products. ● Don't put the chair directly under the sun or other high temperature places. ● Don't put in the space of dust serious or corrosive gas environment, ● Don't put the chair in a small space places or use in the bad air circulation places. ● Don't use the chair outdoor. 	To avoid fade, discolor on upholstery or hardened, deteriorated on PU.



Caution

	<ul style="list-style-type: none"> ● Keep Dry-Don't use or store the chair in the wet environment like nearing the swimming pool, or bathroom. ● Keep the chair and remote control dry all the time. ● Do not use it when user's body is wet. 	To avoid leakage or electric shock.
	<ul style="list-style-type: none"> ● Make sure to install the earth wire in correct way(Incorrect install way may cause electric shock. If you don't know how to install, please find a professional electrician) ● Don't use plug adapter (If the enclosed plug doesn't match with socket, please don't change the plug by yourself and find a professional electrician to install a matched socket.) 	To avoid electric shock.
	<ul style="list-style-type: none"> ● Unplug the power before cleaning the chair. ● Unplug the power after using the chair. 	To avoid electric shock or fire harzard.
	<ul style="list-style-type: none"> ● Unplug the power when any damage on the power. 	
	<ul style="list-style-type: none"> ● Hold the plug to unplug the power but not try to pull the wire to unplug the power. 	To avoid accidents
	<ul style="list-style-type: none"> ● Please turn off the power switch and unplug the power after massage. ● Unplug the power immediately when electricity goes off. 	To avoid damage or accidents when power on again.

Usage environment	Environment temperature : 0°C~35°C Relative humidity : 20%~80%
Storage environment	Environment temperature : -5°C~35°C Relative humidity : 20%~80%

Grounding instruction

- ✧ ※The chair is equipped with a cord having a grounding conductor.The plug must be plugged into an appropriate socket that is properly installed and matched with the plug.

Replace fuse

- ✧ ※When the fuse is burned out, please turn off the switch and unplug the power. Opening the lid covered the fuse which is located in the switch box. Using a same size fuse to replace the old one, then cover the lid. Or you can find an electrician to replace the fuse.

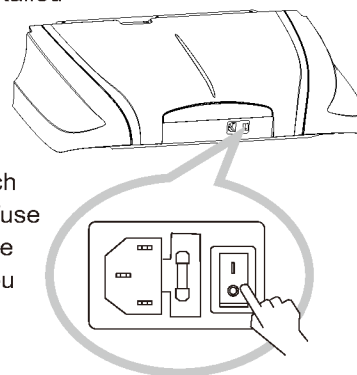

Earth wire is not allowed to be in these places

Gas pipe: probably cause explosion or fire.
Phone wire and lightning rod: probably cause electric shock and fire when thundering.
Water pipe: earth wire is useless where there are plastics

External structure

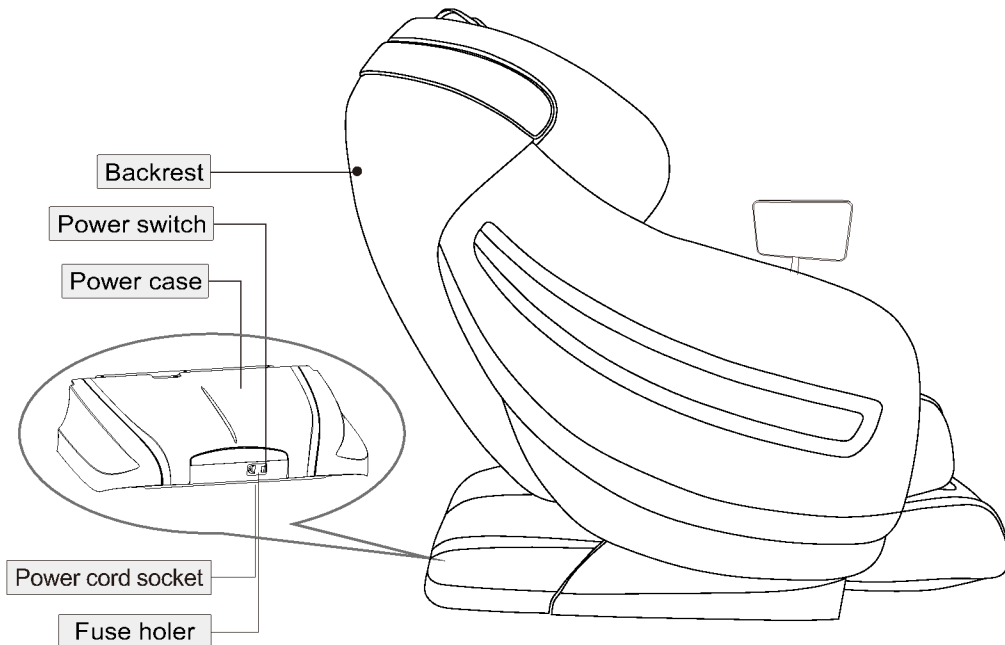
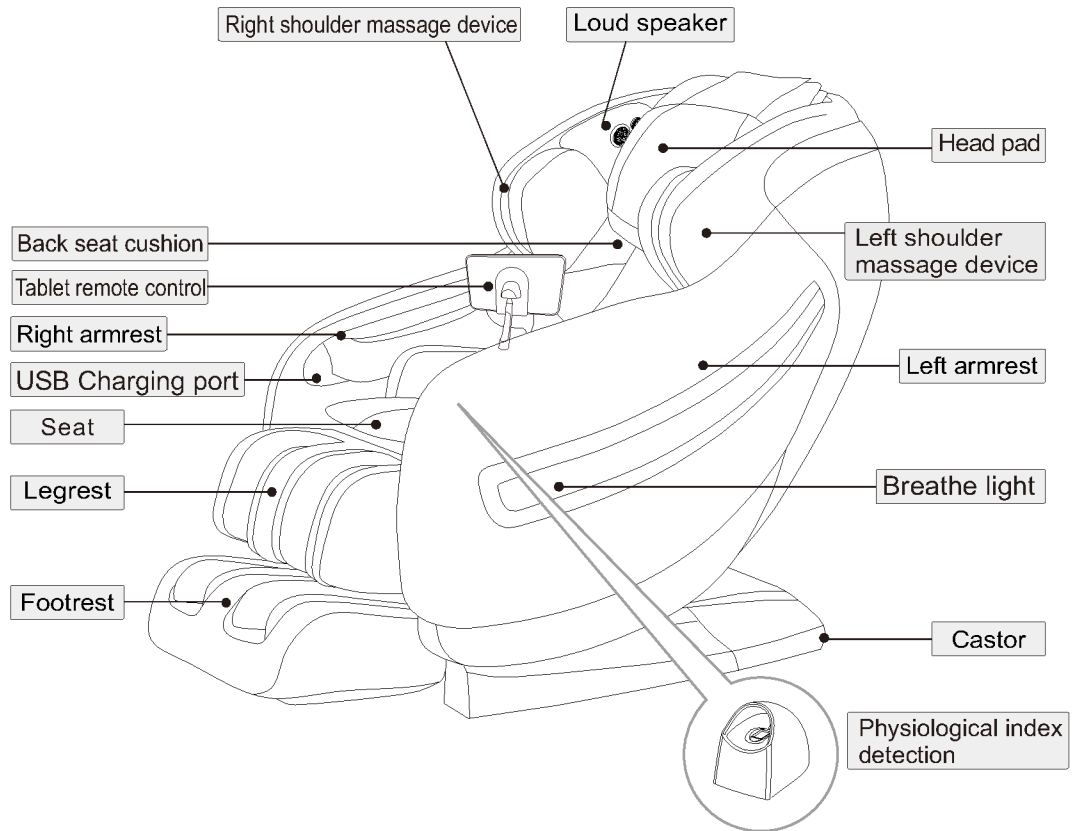

Internal structure

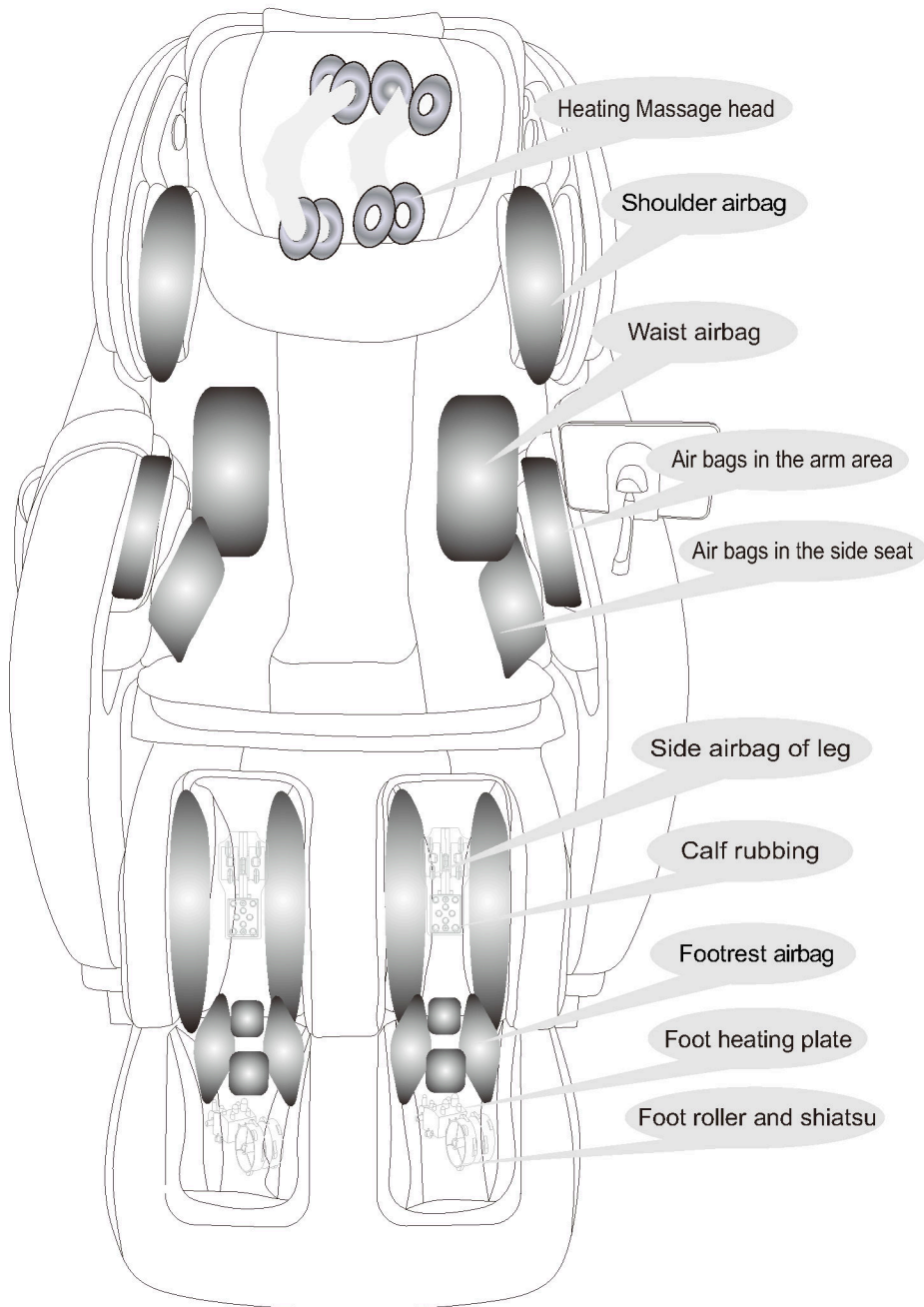

Explosion Diagram

Preparation

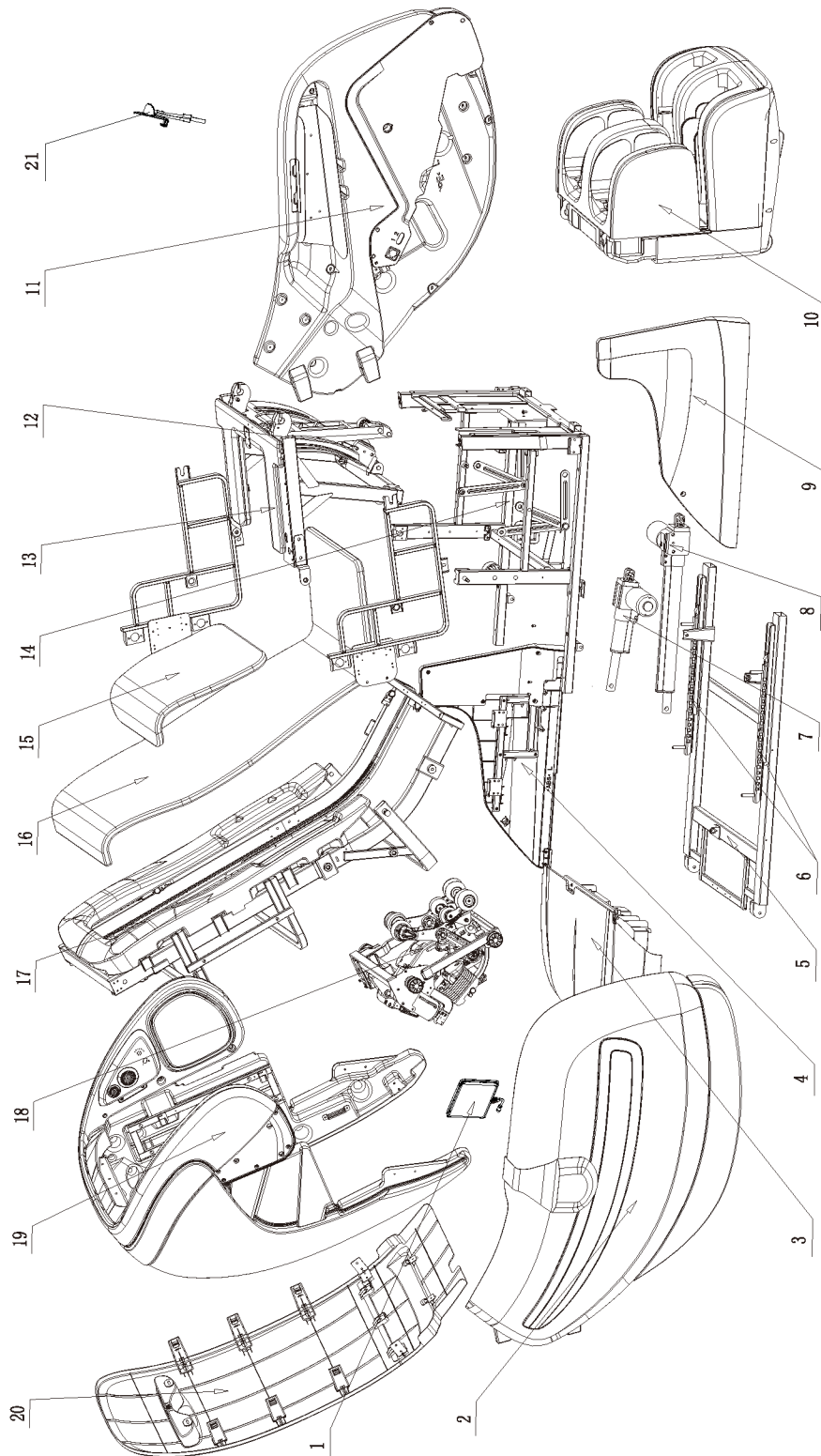

Mechanical components list

NO.	Name	Q' ty	NO.	Name	Q' ty
1	Tablet remote control	1			
2	Right armrest assembly	1			
3	Power case assembly	1			
4	Left side fender	1			
5	Base assembly	1			
6	Sliding rail	2			
7	Seat electric actuator	1			
8	Backrest electric actuator	1			
9	Right side fender	1			
10	Foot and leg assembly	1			
11	Left armrest assembly	1			
12	Footrest electric actuator	1			
13	Seat frame surface assembly	1			
14	Seat bottom frame assembly	1			
15	Pillow	1			
16	Back and seat cushion	1			
17	Backrest assembly	1			
18	Massage machine	1			
19	Shoulder device assembly	1			
20	Back cover assembly	1			
21	Tablet bracket and bolt	1			

Installation (1)

Step 1. Take out the main body and accessories from the carton box.

- ① Take out the accessories boxes and the main chair from the carton box by at least three people .
- ② Confirm all the accessories.

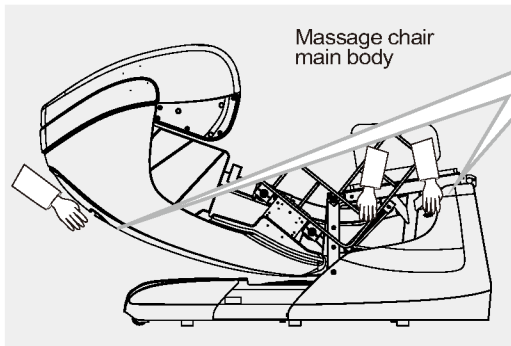

Massage chair main body

Two people grasp left and right seat metal frame ,the other one catch handling position of the back cover, then take the main body of massage chair out of the box .

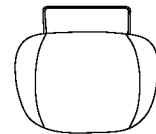
The accessories

Head pad

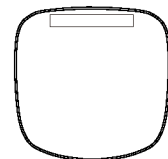

Shoulder cushion

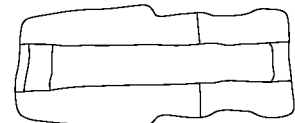

Back seat cushion

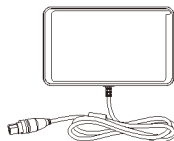

Tablet remote control



tablet bracket and bolt

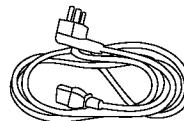

Electric power cable

- ③ Take out the left ,right armrest from the amrest carton box,put the armrest on the table or ground in flat(pay attention to prevent scratches)

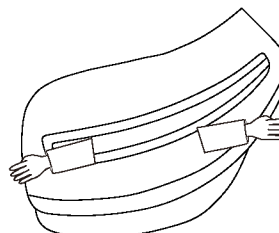

Left armrest

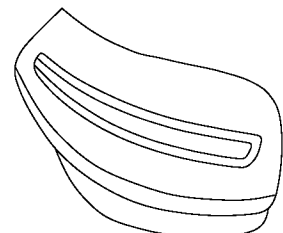

Right armrest

- ④ Taking out the legrest device from the legrest carton box,catching the left and right two sides of the legrest and take them out.

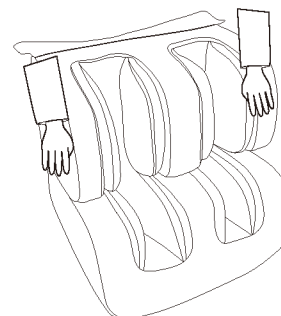

Legrest device

Installation (2)

● Check environment

- Make sure the recline space.

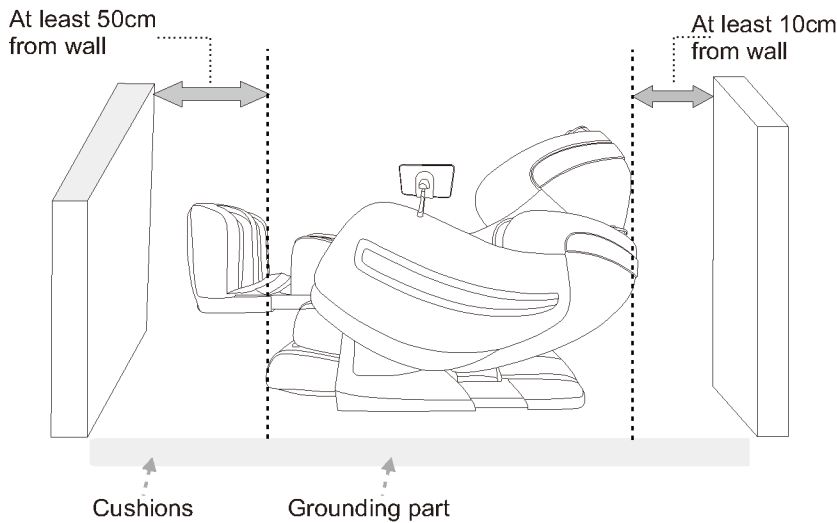

Because the chair is heavy, it may ruin your floor in long time setting.
Please put a blanket or other soft things to protect your floor.

Caution:

- Don't use the chair in wet places like near swimming pool, bath room to avoid leakage or electric shock.
- Please use chair in flat place to avoid chair falling or noise or other unexpected trouble.
- Don't use under sunlight or near stove or other heating place to avoid upholstery deteriorated.

Installation (3)

Step 2. How to assemble the legrest

- ① Unscrew the bolt from hanger of legrest.
- ② Connect the legrest's air hose with the corresponding air nozzles of the main body tightly.
- ③ Plug power adapter into outlet.
- ④ raise the rotation shaft board on hangers, raise the legrest with hands, put rotation shaft into hangers on main body, and put rotation shaft board down.
- ⑤ Screw it back tight.
- ⑥ Connect the legrest leather piece with seat by velcro .

⚠ Caution: Make sure the air tube and wires cannot twist together.

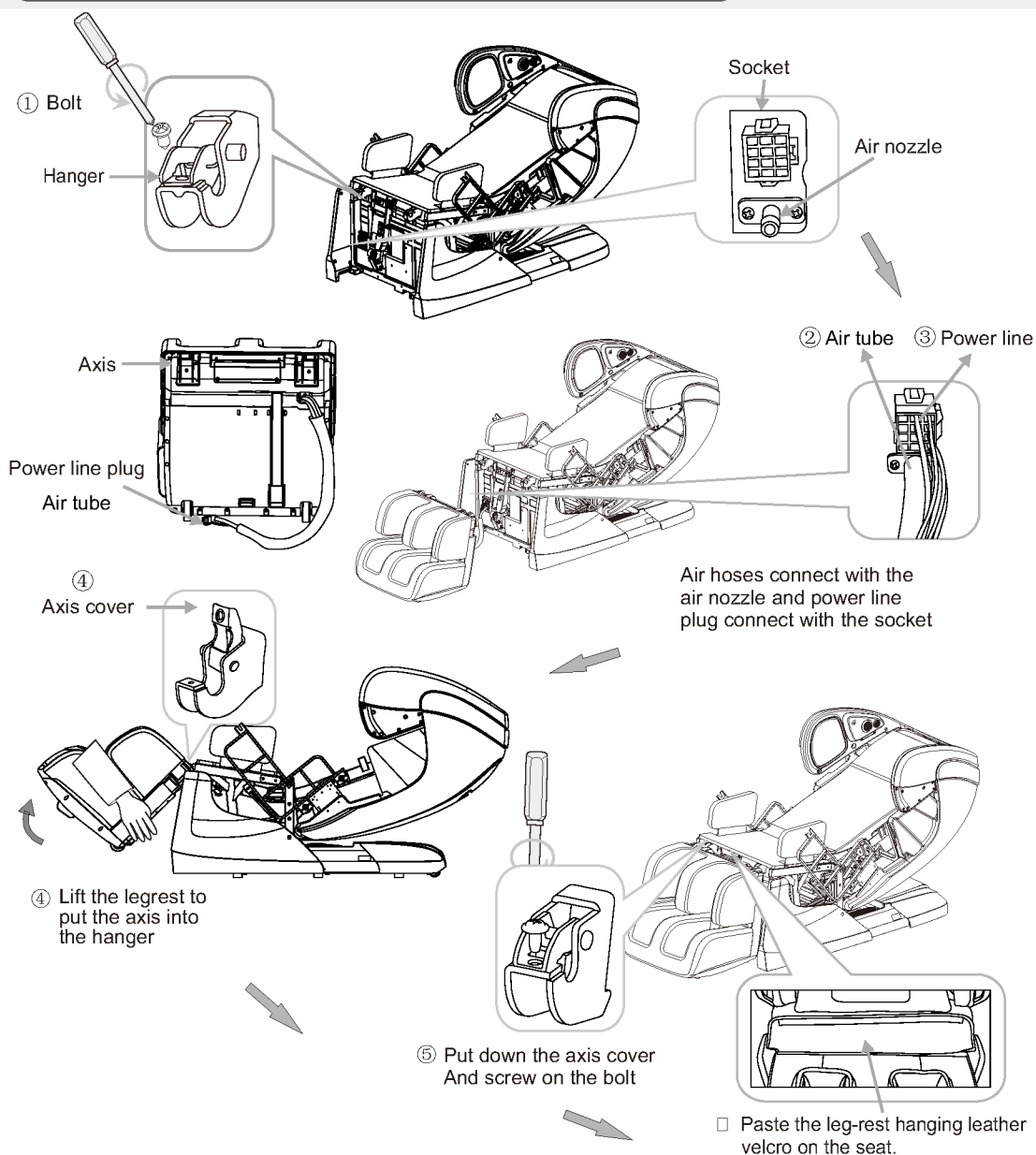

Installation (4)

Step 3. How to assemble the left and right armrest

- ① Push the shoulder plastic part inside to 40-50mm by your hand.
- ② Put the armrest close to the main body side, lift up the front of the armrest then insert the main body side frame and push back.
- ③ Put the power plug into the socket.
- ④ Connect the air hose of armrest with the air tubes on the seat tightly, the black air tube should be connected with the air hose marked with "1" and the grey air tube should be connected with the air hose marked with "2".
- ⑤ Insert the rear armrest fixed plate into the fixing hole on the chair body.
- ⑥ Unzip the shoulder airbag, screw up the outside of airbags by 2pcs M6*20 screws, and then lift up the airbag, put 1pc M6*30 Screw inside the hole and then screw up, zip up.
- ⑦ Remove the rubber plug of the armrest, spin the screws inside the hole tightly then put on the rubber plug tightly.

CAUTION: Do not squeeze the air tubes during the installation. This may cause air leakage or the air bags are not inflatable.
Please make sure that the fixed plate and LED wire need to be plugged firmly, otherwise the armrest may drop or LED light does not shine.

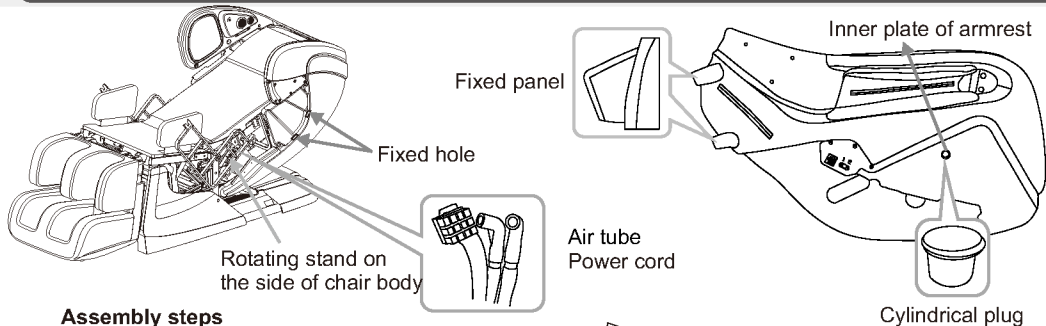

Assembly steps

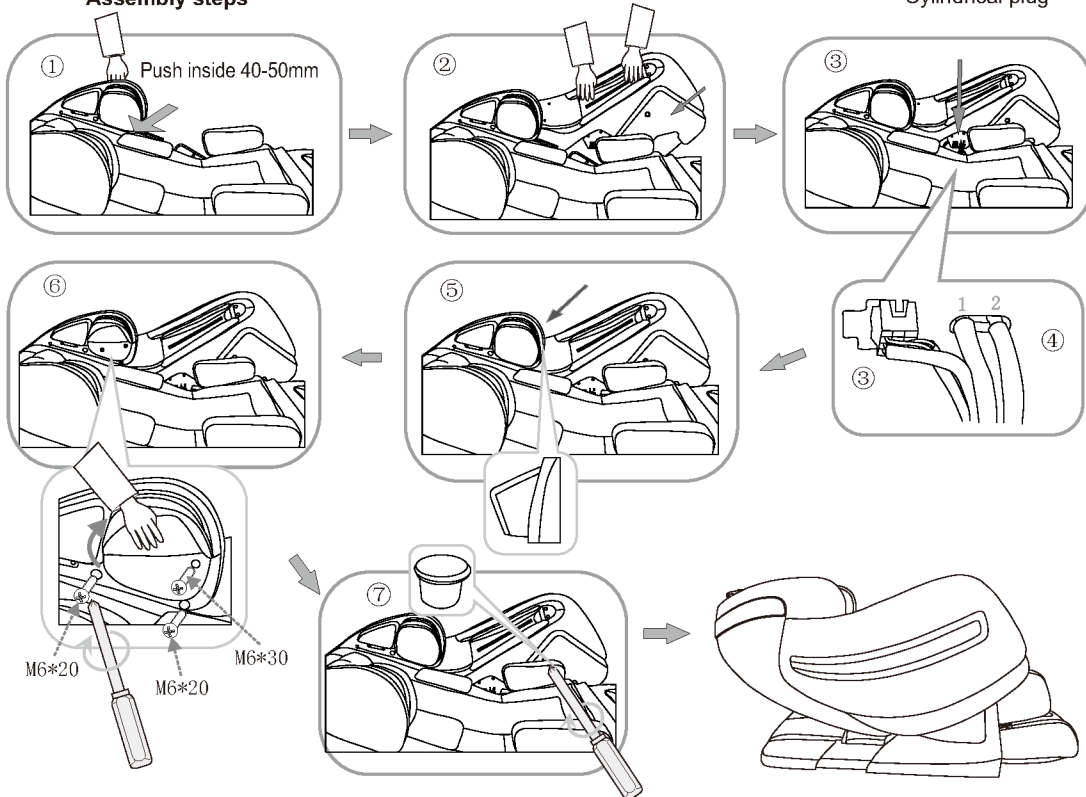

Installation (5)

Step 4. Install the tablet and the bracket.

- ① Install the pocket into the right armrest, can put your mobile or other small things.
- ② Put the bracket into the bracket seat on the left armrest according to the shape of the bracket and the seat hole.
- ③ Use the M6*16 knurled screw to tighten the bracket from the inner hole of the left armrest.
- ④ Put the tablet on the bracket.
- ⑤ Put the tablet cable across the wire clip at the left side of the seat, put the plug dent alignment the bump position then joint them together and tighten them up with the nut.

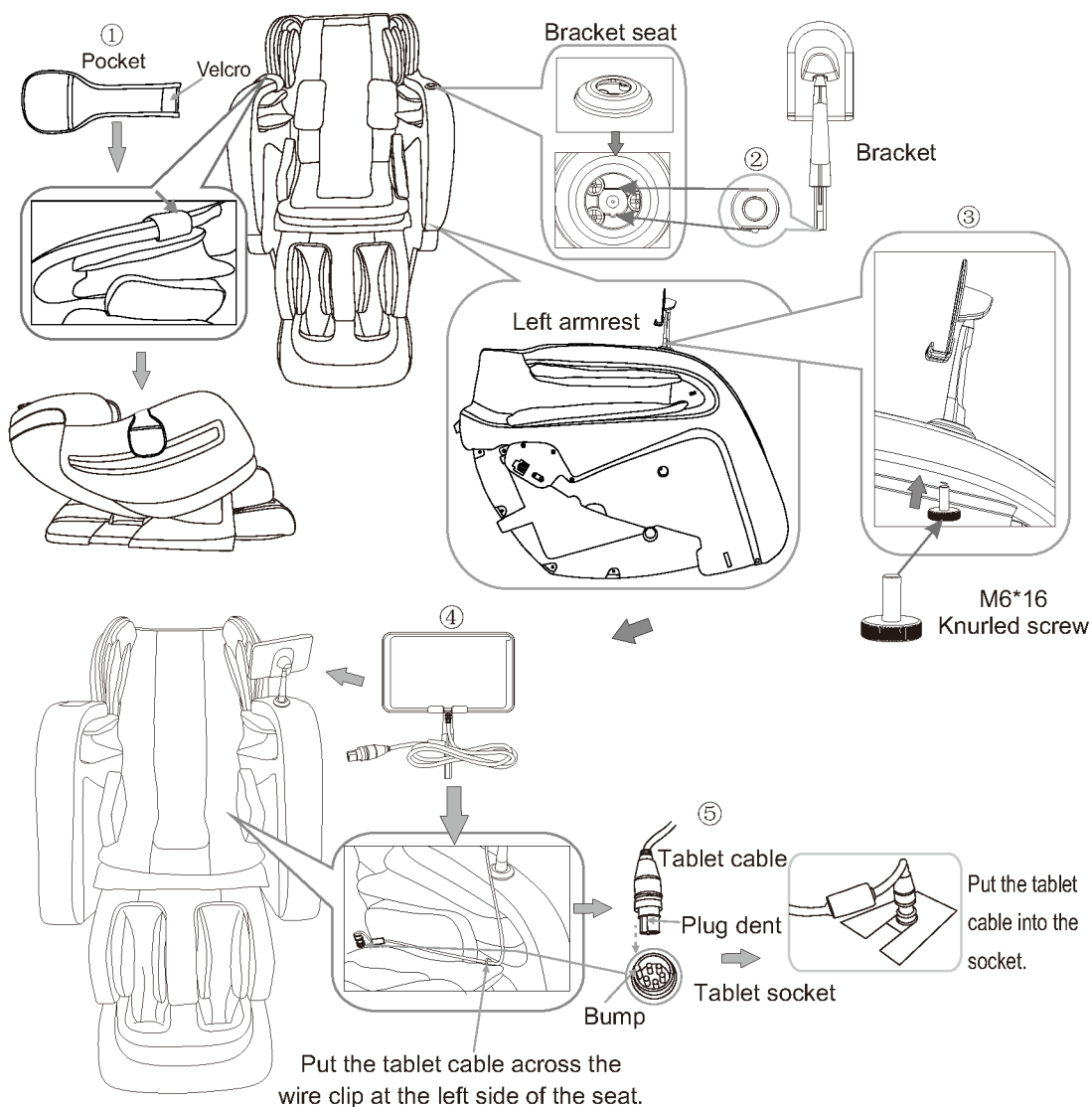

Installation (6)

Step 5. Restore the chair.

- ① Plug the cable line in the hole a on the power box as shown in the right picture.
- ② Insert the plug of cable line into the socket.
- ③ Turn on the switch behind the power box. (Switch on/off "O/I", press I down to turn it on.)
- ④ Switch off, chair resets to upright state.
- ⑤ Use the hand controller to choose massage functions, enjoy the relax and comfortable massage by our products.
- ⑥ In ON status, the USB port can be used for charging mobile. Do not move the mobile during charging.



Make sure the switch is off before you insert the plug of cable line into the socket.

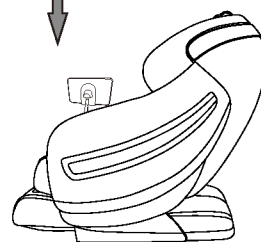
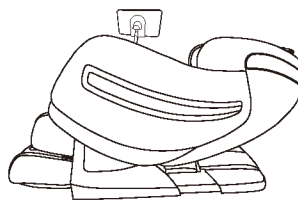
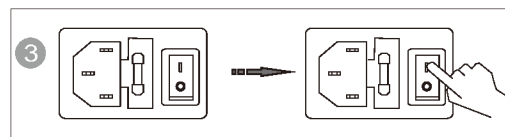
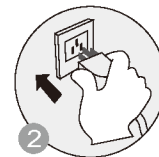
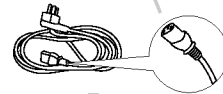
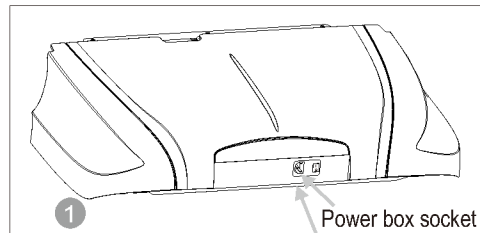

④ Chair resetting status

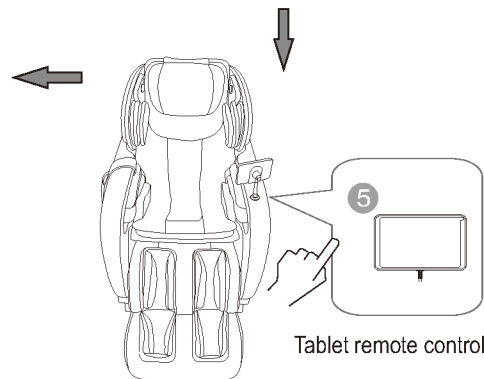
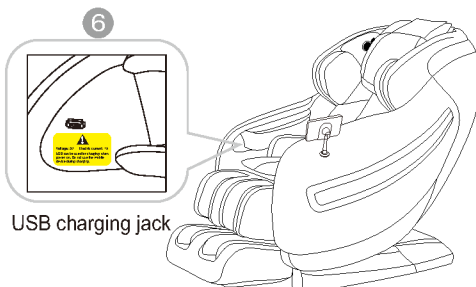

Environment

**Caution**

Don't use the chair in wet places like near swimming pool, bath room to avoid leakage or electric shock.



Don't use under sunlight or near stove or other heating place to avoid upholstery deteriorated.



Please use chair in flat place to avoid chair falling or noise or other unexpected trouble.

- **Check places in front**

Check the areas when back and leg extending, make sure no people, pets or other things around.

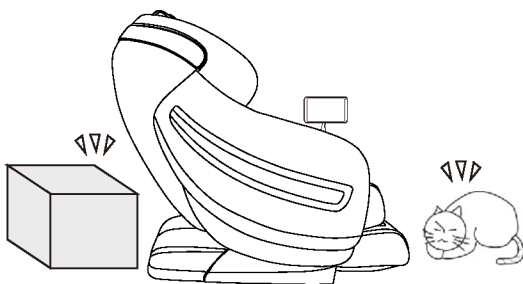

- **Check power cable, plug**

- (1) Clean the dust on plug on time.
(using dry cloth).
- (2) No damage, re-do, bend, stretch, tie or press with heavy thing(especially can't be pressed by the chair) on power cable.

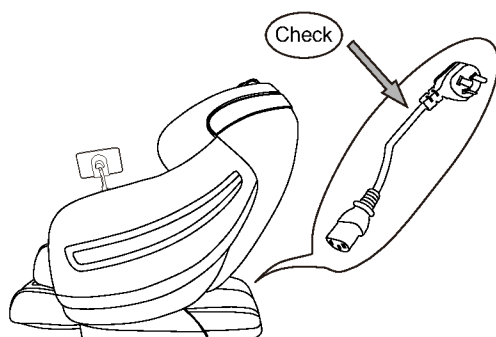

Check environment

- **Space size for using the chair**

- At least 10cm from wall.

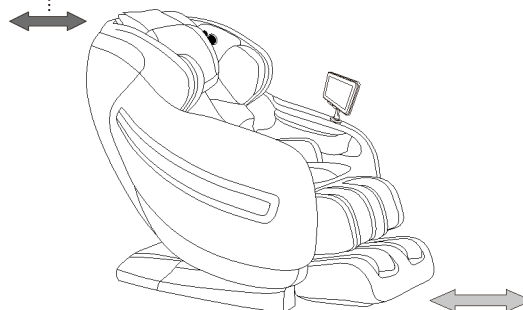

- At least 50cm in front of the leg.

- **Check surroundings**

When the backrest or legrest reclines or extends, please pay attention to:

- (1) Check any person or things in every direction.
- (2) Check the space size.

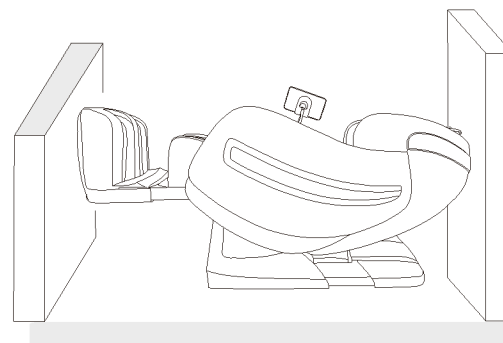
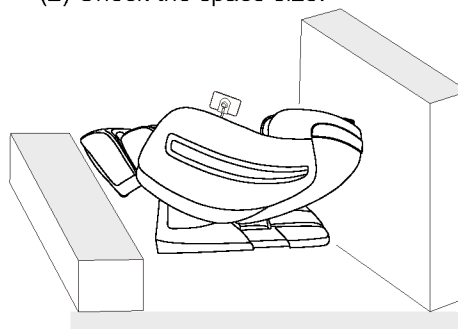

How to move massage chair



Caution

- ✦ Don't move chair when it's working in case of accidents or damage

How to move

- ✧ Bind the cables and put them in the seat to avoid damage when moving.
- ✧ If you plump the chair, it may damage the inner parts of the chair.
- ✧ Don't use the castor if the floor is wooden or other easy damaged material. It will need 2 or more persons to lift the chair.
- ✧ Make sure the power is off and the plug doesn't touch the floor (It's better to let the chair in standing status to avoid the back crashing the floor)



Normally

- 1 Press down the head part to make the gravity fall on the back castors. Then push the chair to desired destination steadily and set it down slowly.

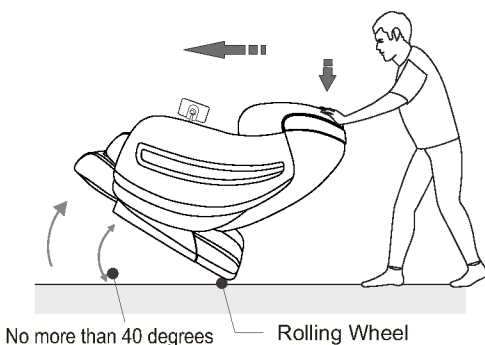

Please hold the footrest to move the chair as shown in the picture in case any scratches on the leatherette

During massage chair backrest lie down process, can't move the armrest.

Adjustment before massage

● Before adjustment

- ✦ Make sure the massage machine rollers stop under the seat, then sit on the chair slowly.

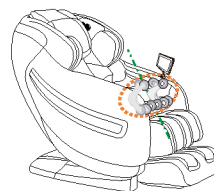

- ✧ To avoid injury caused by wrong position of the massage head.

- ✦ When doing Acupuncture Point Detecting, if the massage head can not find the shoulder position, it will default to the middle part.

Right position: Your back cling to the chair back, the head clings to the pillow.



The remote control will beep once the body scan starts working. When you hear that beep sound, you can press the up/down key on the control to manually adjust the shoulder position.

- ✧ Avoid a wrong detection of your shoulder position which will influence the massage comfort.

● Kind suggestion

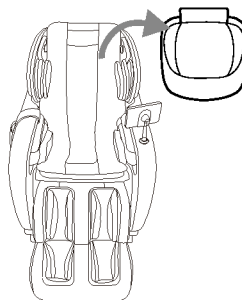

- If you feel the massage isn't strong enough, you can remove the pillow and shoulder cushion.

- Because the chair is heavy, it may ruin your floor in long time setting. Please put a blanket or other soft things to protect your floor.

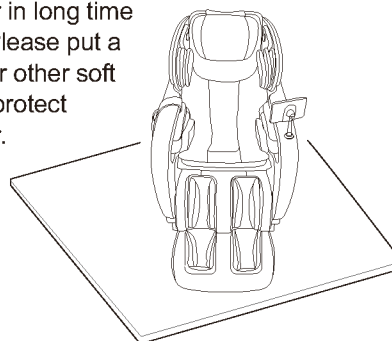

Tablet Remote Control Operation

Top Face of Tablet Remote Control

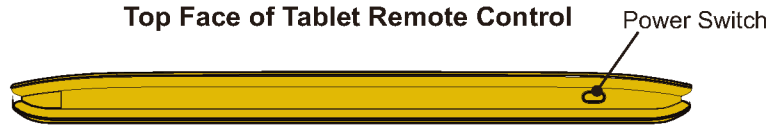

Tablet Remote Control



1. After switching on the chair , press the power switch on the right of tablet remote control top face for 3 second, the LCD screen will light up and display the main interface and enter main interface I.



Main Interface I

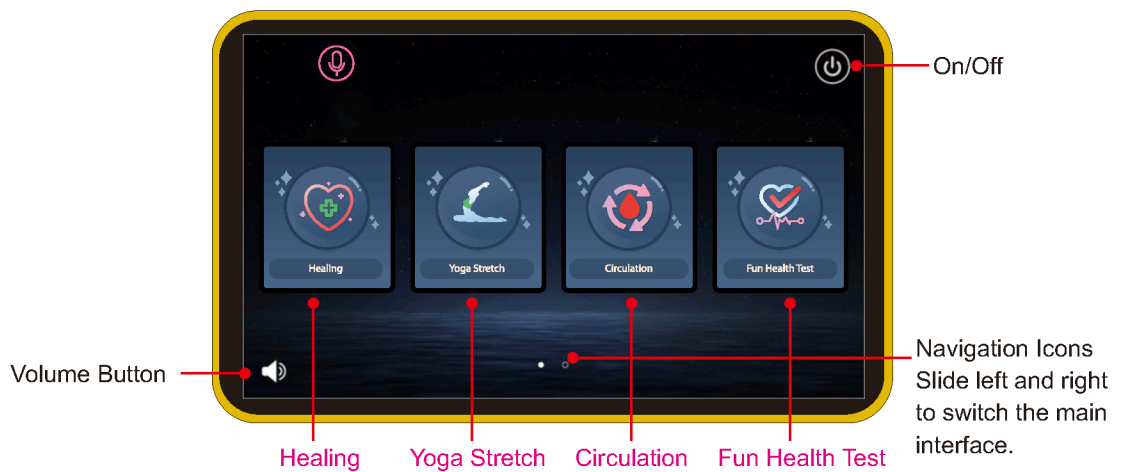

Tablet Remote Control Operation

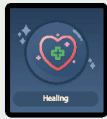

In the ON status, press this icon to enter Healing mode, default working time for this auto program is 8 minutes. (See the interface introduction for details.)

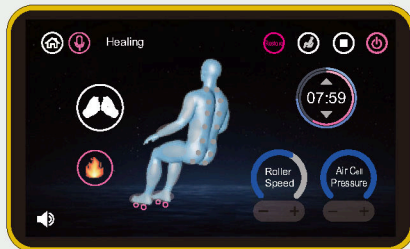

Healing Interface

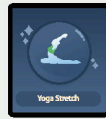

In the ON status, press this icon to enter Yoga Stretch mode, default working time for this auto program is 20 minutes.

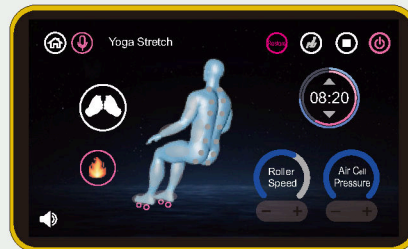

Yoga Stretch Interface

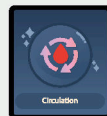

In the ON status, press this icon to enter Circulation mode, default working time for this auto program is 20 minutes.

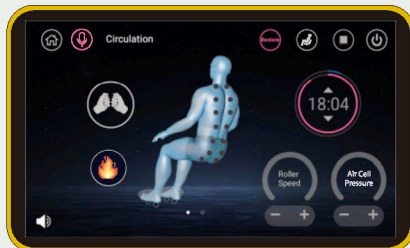

Circulation Interface



In the ON status, press this icon to enter Fun Health Test interface. (See the Health Test interface for details.)

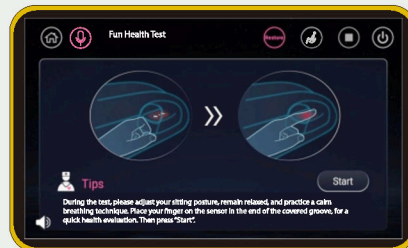

Fun Health Test Interface



Press On/Off key to enter power-on status, press Menu to select any auto or manual program, the massage chair will start body scanning and then begin the massage. Press On/Off again, the chair will power off and restore to its upright position, APP interface will return to main interface I.



Press the Volume button, the volume adjustment key will pop up. This Volume button will always be shown in all interfaces.

Tablet Remote Control Operation

Main Interface I

Healing、YogaStretch、Circulation and Fun Health Test Care Status Pages

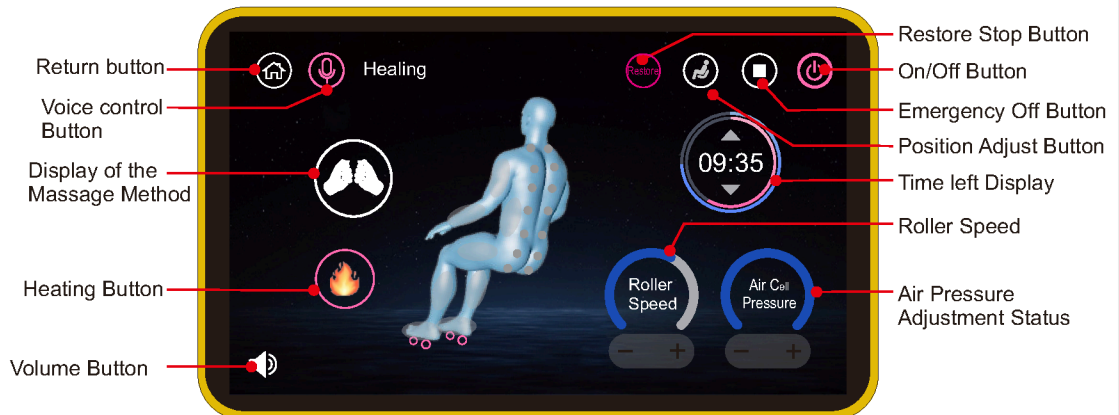

"Return" Press this button, return to the home page.



"Voice prompt", after clicking Voice control button, prompt page.



Massage position



"Knock" massage method status display.



"Knead" massage method display.



"Tap" massage method status display.



"Shiatsu" massage method display.



"Heating" icon lights up, the heating function is on; If not light up, heating function is off.



Restore Stop, when massagechair is turned on, this button will light up by default, if we turn off the chair, the chair will restore, press this button now and it won't light up, if we turn off the chair now, the chair will not restore.



Position adjustment button, click and enter the position adjustment interface.



The "emergency stop" button, click to turn on after click, stop all at this time Massage function, you need to press the button twice to close the massage chair After that, the function of the massage chair can be used normally.



Massage time left and adjust button, shows the time left for the current massage function, Up and down arrow key can add or reduce the time.



Roller speed adjustment, has fast and slow two levels.



Air pressure adjustment button, totally has 5 levels, press "+" or "-" to adjust the air pressure intensity. In auto program, the lowest level of air pressure is "1"; in manual mode, you can turn off the air pressure function.

Position Adjustment Interface

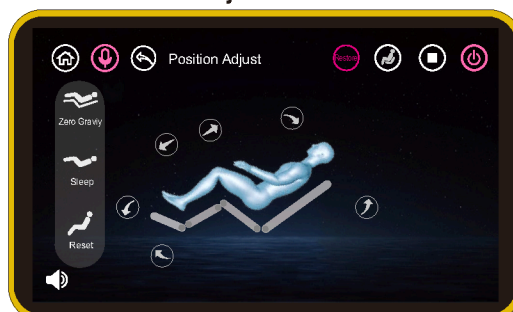

"Return" button, click to light it up and return to the previous menu.



"Zero gravity" button, click to light it up and turn on the first level of zero gravity function, the backrest will lie down and the footrest will rise up, click again to open the second level of zero gravity function, click it for the 3rd time, the zero gravity function will shut down, the backrest will rise up and the footrest will fall down, also the icon will reset to the default status.



"Sleep mode" button, click to light it up, the chair's backrest will lie down and the footrest will rise up.



"Reset" button, click to light it up and the chair's backrest will rise up and the footrest will fall down.

Tablet Remote Control Operation

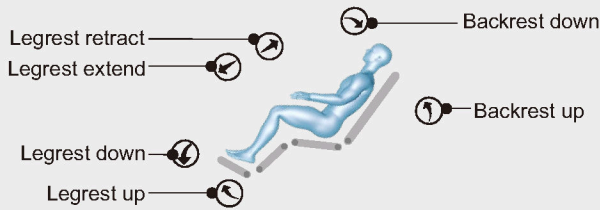

Voice prompt interface

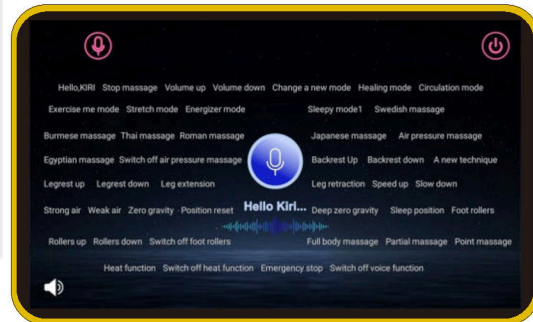
Main Interface
Health Testing Interface

During testing,
human body
shows status

Remind before
testing

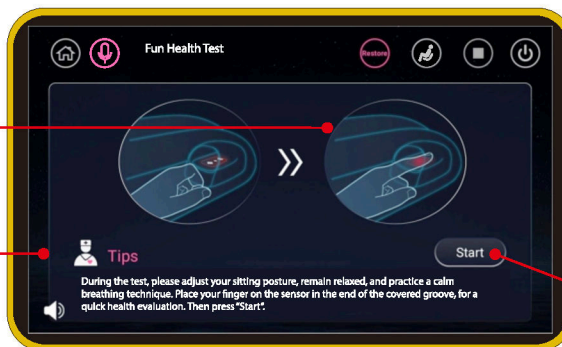

Note: please make sure wifi is
connected before health testing

Guidance before testing: sit in
the chair, put your forefinger on
the test device, keep relaxed,
adjust even breathing, click
START key to enter test
interface.

Start

Massage operation

Testing time is about 40 seconds, heart
rate wave will be displayed, heart rate
real time data, blood oxygen data, micro
circulation data.

Data displayed in the diagram is just for
your reference, after testing is completed,
report details will come out as following:

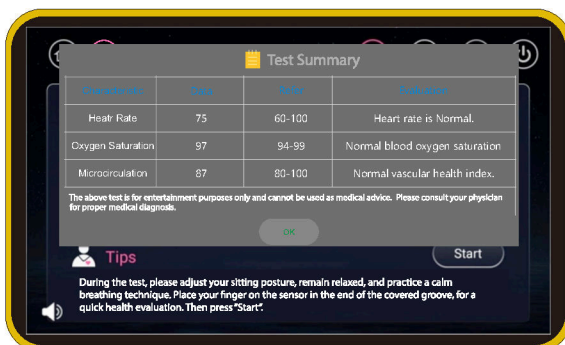
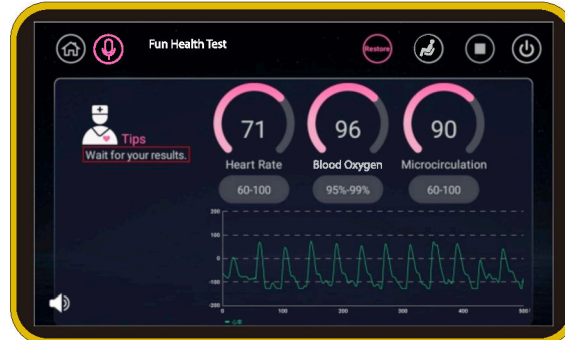

Test report will display three data for
reference, evaluation and suggestion, click
confirm key to end the test. If fail to test, a
prompt box will popup as follows:

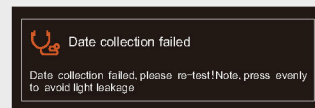

please follow the suggestion to start
second test.

Please make sure that the wifi is
connected before testing.

Data that is displayed in the diagram is
just for your reference.

Tablet Remote Control Operation

Main interface II

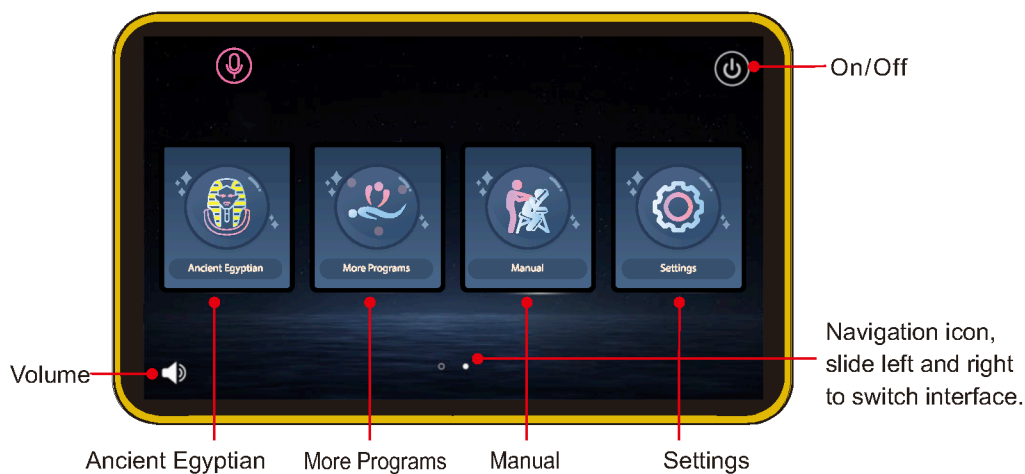

Massage operation



In the ON status, press this key to enter Ancient Egyptian program, the default working time is 20 minutes.

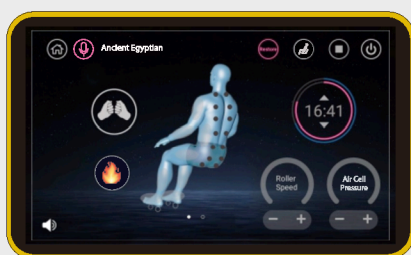

Ancient Egyptian Interface

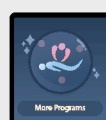

In the ON status, press this key to enter More Programs, 8 special auto programs for your option. (See More Programs introduction for details).

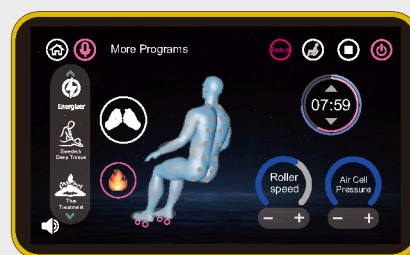

More Programs Interface



In the ON status, press this key to enter Manual program interface. (See Manual interface introduction for details).

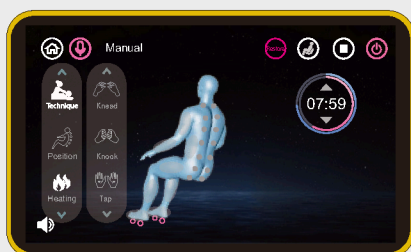

Manual Interface



In the ON status, press this key to enter Settings interface. (See Settings interface introduction for details).

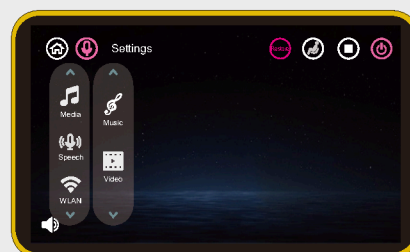

Settings Interface

Tablet Remote Control Operation

Main interface II More Programs

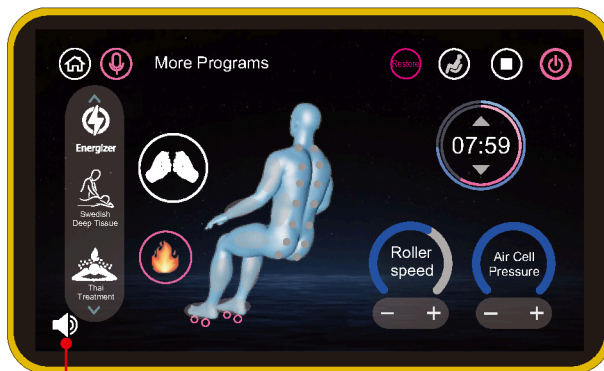

More Programs Display Area



Energizer

In the ON status, after clicking this button, the icon lights up, the "Energizer" is turned on.



Swedish Deep Tissue

In the ON status, after clicking this button, the icon lights up, the "Swedish Deep Tissue" is turned on.



Thai Treatment

In the ON status, after clicking this button, the icon lights up, the "Thai Treatment" is turned on.



Ancient Roman

In the ON status, after clicking this button, the icon lights up, the "Ancient Roman" is turned on.



Japanese Healing

In the ON status, after clicking this button, the icon lights up, the "Japanese Healing" is turned on.



Burmese Therapy

In the ON status, after clicking this button, the icon lights up, the "Burmese Therapy" is turned on.



Sleepy

In the ON status, after clicking this button, the icon lights up, the "Sleepy" is turned on.



Exercise

In the ON status, after clicking this button, the icon lights up, the "Exercise" is turned on.

Massage operation

Main interface II Manual Massage Interface



Manual Display Area

Mode Display Area



Technique

In the ON status, after clicking this button, the icon lights up, one menu will pop up and display knead, Knock, Tap, Knead+tap, Shiatsu, five kinds of massage technique.

Tablet Remote Control Operation

Main interface II

Manual Massage Interface



Manual Display Area

Position Display Area



Position

In the ON status, press this key, the icon is bright, the position manual pops up and displays whole, Section and Focus. When you click fixed point, upward and downward key will pop up while the whole and partial key will disappear. Click the partial key again, upward and downward key will disappear while the whole and partial key appears.



Manual Display Area

Heating Display Area



Heating

In the ON status, press this key, the icon is bright, heating manual pops up and displays mechanism heating, foot heating, click the right key to turn on/off heating function.

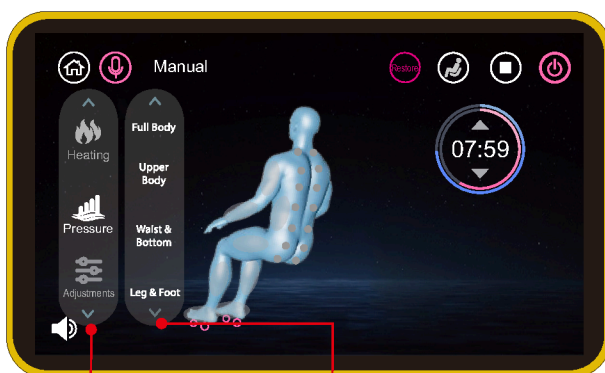

Manual Display Area

Air Pressure Position Display Area



Pressure

In the ON status, press this key, the icon is bright, air pressure massage position manual pops up and displays full-body, hand & shoulder, waist & seat and legrest key. Click the corresponding button, after the icon becomes bright, you can enjoy the air pressure massage.

Tablet Remote Control Operation

Main interface II

Manual Massage Interface

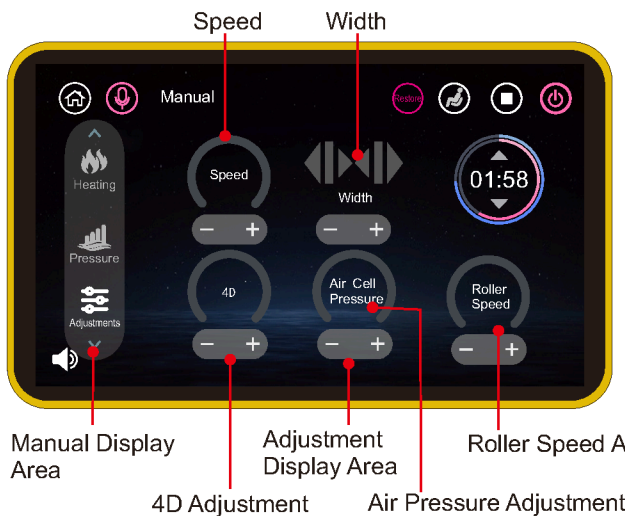

Adjustment

In the ON status, click this button to light up the icon, the adjustment button pops up, you can adjust the back roller speed, massage machine width, 4D, air pressure and foot roller speed. Back roller speed and air pressure adjustment has 5 levels while 4D adjustment has 4 levels, massage machine width adjustment has 3 levels, foot roller speed has 2 levels. Adjust the level by clicking on "+" "-".

Main Interface II

Settings Interface

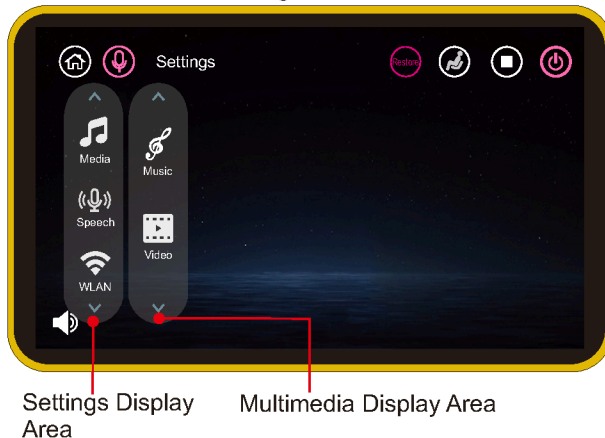

Media

In the boot state, click this key icon Turn brighter and pop up music and video buttons. Click the music to open the YouTube sound Le website, click the video button to play. Open YouTube Video Website. Music And video programs need to click back key back To A P P. At this time music or videos will stop playing.



Speech

In the start state, In the start state, voice recognition microphone The default is to open the state, click to close after clicking, The icon becomes gray.



WIFI

In the ON status, click this button to light up the icon, WIFI can be configured, available WIFI will pop up, WIFI network can be used once the connection is successful.



Language

In the power-on state, when you click this button, the icon will light up, and the language menu will pop up, displaying Chinese, English and Korean. Three languages can be selected, and the default is English.



Touch sound

In the boot state, click this key icon Break -up, the key will have a touch, again click to close this feature.

How to use the tablet controller

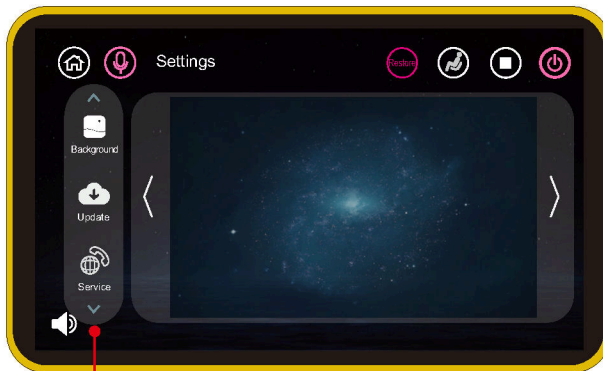
Main interface 2
Settings interface

Background

When the power is on, click this button and then the icon brightens, the background selection menu pops up.

Swipe left and right to select the background. The background will take effect after swiping.

Settings display area

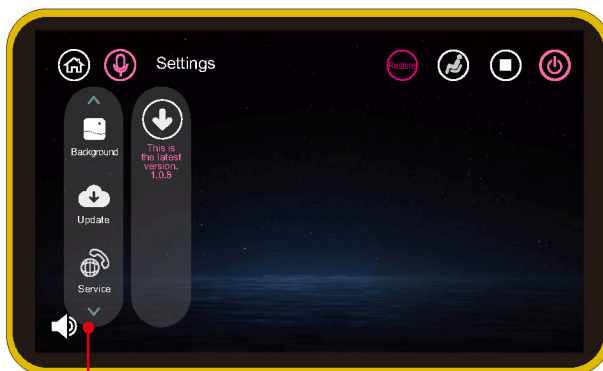

Update

When the power is on, click this button then the icon brightens, you can check if there is a new version can be updated. If there is a new version, there will be prompt for new version update, select update and it will update the program. Otherwise, it will show it is the latest version.

Settings display area



Service

When the power is on, click this button and then the icon brightens, display company introduction and phone of customer service, website and other content.

Settings display area

Voice control use method

The use of smart voice control (has voice control function)

In the standby state, press the power switch of the tablet hand controller to enter the starting state. At this time, the voice recognition system enters the waiting state.

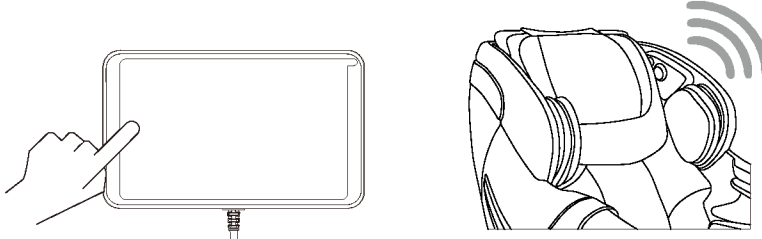

- When using the voice recognition function, you need to say the "Kiri Kiri" system first to identify the subsequent voice command entry; after opening the voice mode, If the voice command entry is not spoken in 8 seconds, the system automatically close the voice mode.
- After the massage chair recognizes the command, there will be corresponding speaker voice feedback, indicating that the command is successfully recognized.
- Please use standard Mandarin to speak the following voice commands. If they are not recognized, please pause for 2 seconds and raise the volume to speak again.
- Voice command entry:

Voice control
Hello,KIRI
Hello,KIRI , Stop massage
Hello, KIRI , Volume up
Hello,KIRI , Volume down
Hello,KIRI , Change a new mode
Hello,KIRI , Healing mode
Hello,KIRI , Circulation mode
Hello,KIRI , Exercise Me mode
Hello,KIRI , Stretch mode
Hello,KIRI , Energizer mode
Hello,KIRI , Swedish massage
Hello,KIRI , Burmese massage
Hello,KIRI , Thai massage
Hello,KIRI , Roman massage
Hello,KIRI , Japanese massage
Hello,KIRI , Sleepy mode
Hello,KIRI , Egyptian massage
A new technique

Voice control use method

● Voice command entry:

Voice control
Hello,KIRI , air pressure massage
Hello,KIRI , Strong air
Hello,KIRI , Weak air
Hello,KIRI , Switch off air pressure massage
Hello,KIRI , Backrest Up
Hello,KIRI , Backrest Down
Hello,KIRI , Legrest Up
Hello,KIRI , Legrest Down
Hello,KIRI , Leg extension
Hello,KIRI , Leg retraction
Hello,KIRI , Speed up
Hello,KIRI , Slow down
Hello,KIRI , Zero gravity
Hello,KIRI , Deep Zero Gravity
Hello,KIRI , sleep position
Hello,KIRI , Position reset
Hello,KIRI , foot rollers
Hello,KIRI , Switch off foot rollers
Hello,KIRI , full body massage
Hello,KIRI , partial massage
Hello,KIRI , point massage
Hello,KIRI , Rollers up
Hello,KIRI , Rollers down
Hello,KIRI , heat function
Hello,KIRI , Switch off heat function
Hello,KIRI , Emergency stop
Hello,KIRI , Switch off voice function

Caution: This function will be updated automatically, may be revised without reminding.

ON/OFF

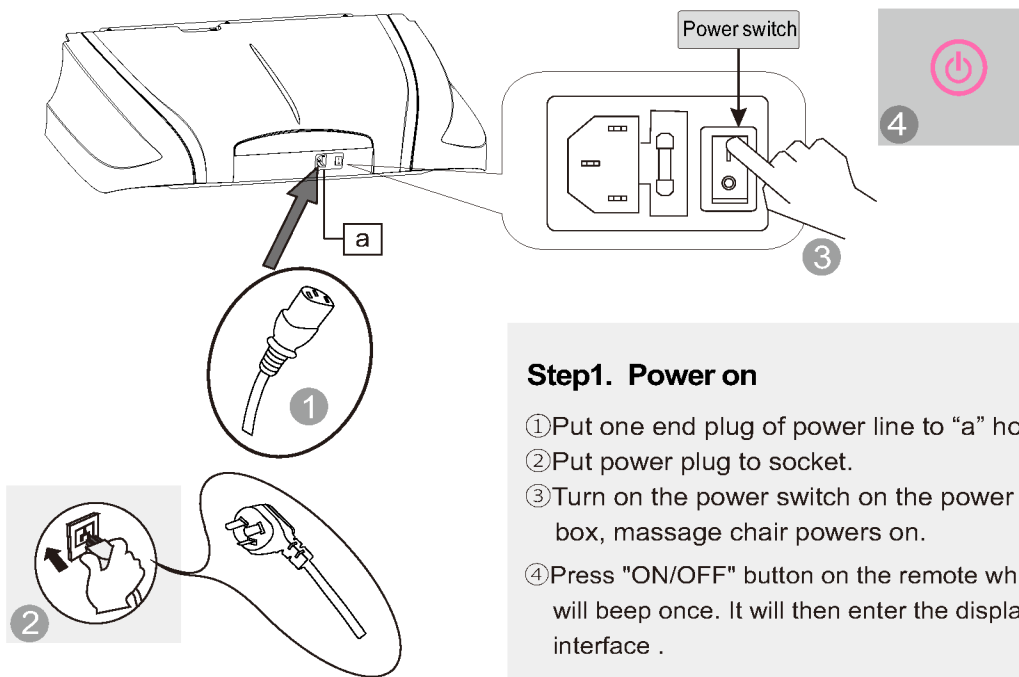
**Step1. Power on**

- ① Put one end plug of power line to "a" hole.
- ② Put power plug to socket.
- ③ Turn on the power switch on the power box, massage chair powers on.
- ④ Press "ON/OFF" button on the remote which will beep once. It will then enter the display interface .

Step2. Massage

- ① Operate according to controller operation instructions. As for the massage method's details, please refer to remote control's Usage page.
- ② When the massage ends, massage machine will return to the default position, meanwhile "Shutting down" will be displayed on the controller.

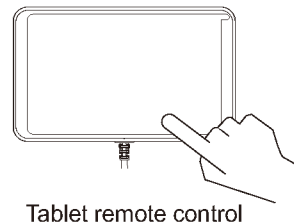

Tablet remote control

Step3. Turn off the power

- ① When the chair is On, press On/Off button to turn off the massage chair and it will restore automatically.
- ② Turn off the power switch on the bottom of the back of chair after the rollers reach storage position.
- ③ Unplug the power plug from the socket.

**Warning**

1. Before using, pull up the pillow, back cushion etc. to check if the PU material is broken, if there is damage, please stop using, unplug the chair, and ask for repairment.
2. Only plug to proper socket.

**Attention**

1. Before sitting down, make sure there is no things pinched between armrest, legrest , backrest and seat of the chair.
2. Make sure the chair is in reset state before using.
3. Do not stand on it when using the massage chair.

Function Illustration

● Legrest Up

Press this button on controller, legrest goes up. Release the button, legrest stops moving, the angle is locked in this position.

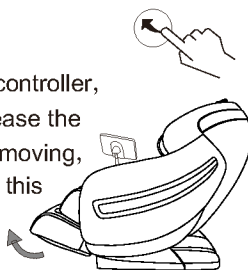

● Legrest Down

Press this button on controller, legrest goes down. Release the button, legrest stops moving, the angle is locked in this position.



● Backrest Down

Press this button on controller, backrest goes down. Release this button, backrest stops moving, the angle is locked in this position.



● Backrest Up

Press this button on controller, backrest goes up. Release this button, backrest stops moving, the angle is locked in this position.



● Zero gravity method

Keep pressing the "zero gravity" icon in tablet controller, the backrest will go downward, legrest will go upward, massage chair posture adjust to zero gravity level 1; press this button again, go into zero gravity level 2; then press the button again, backrest will go upward, legrest will go downward, massage chair return to original position.

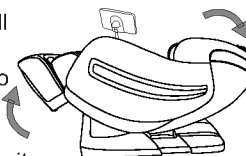

★ Tips: Zero-gravity

is according to the NASA Space capsule relax theory, through the back, seat, legrest three sections multi angle changeable, making the legrest up and seat down can make the angle 128 (+/-7) degrees between Body and legrest..let the heart and knee at the same level, reducing the blood circulation pressure to the lowest, but all the body pressure will put on the buttocks, And because of the ZERO GRAVITY position design, increase the forced area from the body and massage chair, so all the forces can be dispersed to the massage chair, reducing heart and spine pressure, realizing the best Zero gravity massage experience. creating a completely relax, natural and comfortable massage posture.

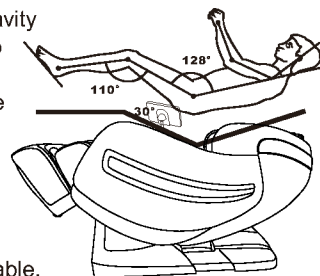

● New Curve rail, Combination of back and buttocks massage.

Massage chair adopts 4D curved rail technology, combining with 4D massage mechanism patent, realizing multi-angle integrated massage for back and buttocks. It has broken through traditional L shape rail's function which can't realize lying flat and stretching, and achieve best massage effect.



1. Please make sure there is no people, no pets or any stuff around the backrest to avoid unexpected hurt or property loss.
2. When adjusting the backrest, be careful of the gap between the backrest and armrest.
3. When the legrest is moving, please do not stand on or leave from the seat, do not stop the legrest from moving in case of causing damage to the chair.
4. Please refer to control instruction for more details.

Function Illustration

● Legrest extend and retract

Legrest can extend and retract within 22cm automatically.

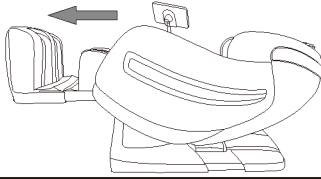

● Arm massage

Massage chair use space capsule type armrest, with built-in pulse air pressure massage function. Put the arms between armrest's air bags. After filling air, achieve kneading massage on the arms and hands. The arms could get comfortable massage in any angle of the chair.

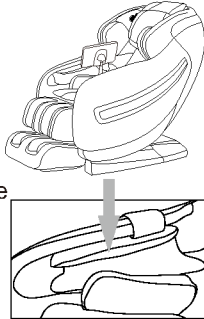

● Shoulder massage

Multi-layer exposed airbags are located on both shoulders to assist with stretch function. The 4D massage rollers push forward your body, while the airbags grip your shoulders to provide the ultimate full body stretch.

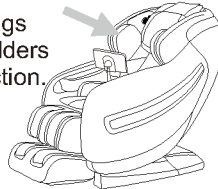

● Leg rubbing function

The innovative leg rubbing technology provides kneading and rubbing massage on the leg muscles, which can effectively relieve the leg aches and restore the leg rejuvenation.

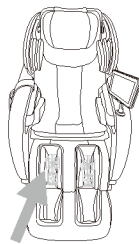

● Health Testing function

It has a health testing function, which can detect the user's heart rate waveform, heart rate real-time data, blood oxygen data, micro circulation data. According to the results of various indicators, combined with the cloud algorithm, it can produce a health test report with human body index parameter and suggestion.

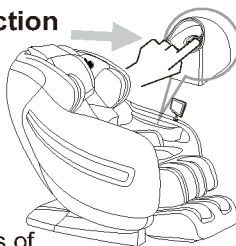

(Please follow the instruction on the tablet controller.)

● Warm foot therapy

Innovatively developed twoway rotary foot kneading technique, realizing the sole function of kneading foot, combining with foot heating, it can perform best foot massage experience, good for health.

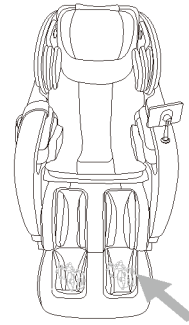

● Music therapy

There are multiple speakers surrounding the headrest. The blue-tooth wireless music player can integrates music into the massage techniques with synchronic therapy, which allow the rollers to massage you to the beats of your music. Relaxing to your own tunes will improve your blood and ease fatigue.

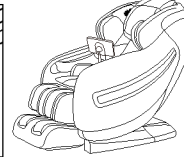
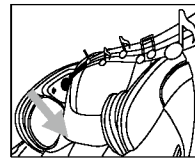

● Foot Safety Pinch Function

When the footrest angle is adjusted, the massage chair can automatically detect the length of human legs. Do not put your feet on the out cover of footrest now, otherwise it will affect the detection of the leg length, resulting in no retraction for the footrest.

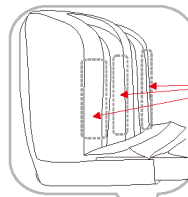

Footrest Out Cover: there are three sensor areas with anti-pinch settings.

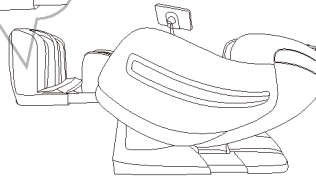

When the massage chair is turned off, do not put your feet or anything on the out cover of footrest, otherwise the footrest will stop retraction. If you can remove the obstacles within two minutes, the footrest will continue to retract automatically, otherwise the legrest can not return to the original position.

Restoration of massage chair

- ① Make sure there is no people or pet or anything within the range of backrest and legrest.

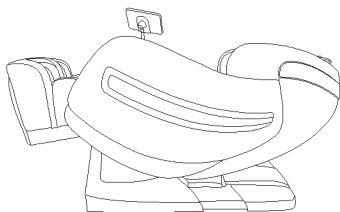

- ② Operate the remote to let the backrest go up and the legrest do down to the normal position.
(or press ON/Off key to make backrest and legrest restore to the normal position)



Or

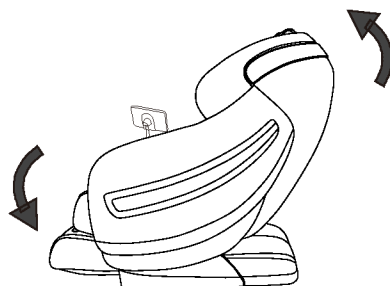

- ③ After the restoration, put the tablet remote back to the bracket on the left armrest.

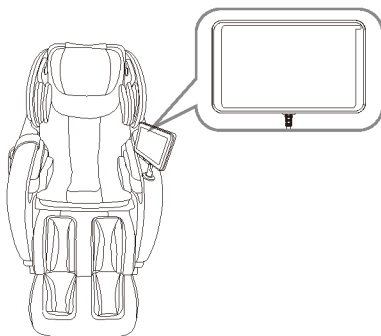

- ④ Switch off the power.

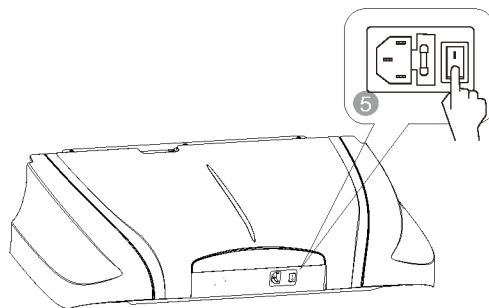

- ⑤ Unplug the electricity from the socket.
(Attention: hold the right plug position)

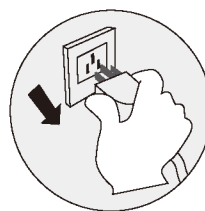

- ⑥ Clean the chair if necessary.

**Attention!**

- After using, press ON/OFF to end all the massage method and wait for restoration. Make sure to cut the electricity to avoid any unexpected hurt to children or pets.
- After using, turn off the power, unplug the electricity. Avoid moisture, dirt and aging of insulation in case of causing damage.

Synthetic leather

● General cleaning

Clean with tidy, soft and dry cloth slightly.



Do not use the thinner, gasoline, alcohol or other chemical materials.

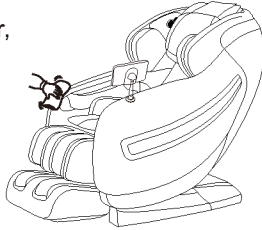

● If leather is dirty

- ① Dip soft cloth into 3-5% neutral detergent solution, squeeze it then clean the stain on the surface gently.
- ② Wash cloth, squeeze it and wipe with detergent.



- ③ Clean it softly with dry cloth.
- ④ Allow to dry (air blower is prohibited)

Plastic parts

- ① Dip cloth into neutral detergent, squeeze it and clean.
- ② Wipe with water-dipped but squeezed cloth.
- ③ Allow to dry.

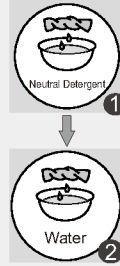

Clean the controller

- ① Wipe with soft cloth after squeezing.
- ② Allow to dry.

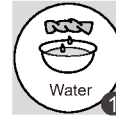

Do not use the thinner, gasoline, alcohol or other chemical materials.

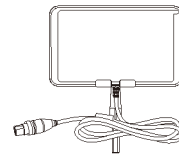

Tablet remote control

Cloth material

- ① Dip cloth into weak neutral detergent, squeeze it and clean the material surface.
- Do not use the thinner, gasoline, alcohol or other chemical materials.
- ② Brush the dirty parts with weak neutral detergent. (avoid excessive brushing)
Excessive cleaning may cause damage to cloth material.
- ③ Wipe with water-dipped but squeezed cloth.
- ④ Allow to dry.



About cleaning

- Before cleaning, unplug the electricity, don't touch plug with wet hands.
- Make sure hands are dry when plugging to the socket.
- If failed to follow the mentioned instruction, user may get electric shock or burned.

FAQ and Troubleshooting

Trouble	Possible reason	Troubleshooting
The massage chair can't work after power is on.	Check if the control is on or not.	Open control switch
	Not choose massage function	Choose massage function
	Check whether the plug and socket in poor contact.	Make sure plug and socket are connected.
	Wire or plug has damaged.	Please ask manufacturer or appointed or authorized maintenance man for checking and replacement.
	The fuse burned out.	Replace fuse of same specification.
	Something wrong with inner circuit	Please ask appointed or authorized maintenance man for checking and repairing.
There is beep sound inside the massager while working.	It is sound of air pump, motor and mechanical parts.	Normal sound, no need to pay attention to it.
Different height of the left roller and right roller.	Massage rollers work on shifts.	Normal, no need to pay attention to it.
Sound suddenly becomes much louder while working.	Check if it is due to long time working.	Turn off the power to have the massager rest for over half an hour before next turn working.
	Inner parts fretted away due to long time work. It's normal	Please ask appointed or authorized maintenance man for checking and repairing.
Massage function suddenly stops while working.	Suddenly power-down	Connect the electricity power again
	Setting time is up.	Turn off the power to have the massager rest for over half an hour before next turn working.
Neither the backrest nor the legrest can be lay down.	Check if there are any obstacles; the chair overloads; for the sake of safety, sometimes the massage machine may automatically stop working.	Remove the obstacles; turn off the power to have the massager rest for over half an hour before next turn working.
The chair can't return to its original position.	Excessive operation; setting time is up.	Please ask manufacturer or appointed or authorized maintenance man for checking and replacement.
Electric wire or plug give out heat	It may work overload	Turn off the power to have the massager rest for over half an hour before next round working.
	Other abnormal case	Stop using, and ask appointed maintenance man for help.



Note: If the troubles are not caused by above reasons, please turn off the power switch and cut off the power, then contact the manufacturer or service agent to repair your chair.

Technical data

Name	Massage Chair	Power	280W
Model	Super MD	NW/GW	Main body: 102/123kg Armrest : 19/24kg Legrest & footrest: 31.5/35.5kg
Input voltage	<input type="checkbox"/> AC120V, 60Hz <input type="checkbox"/> AC220V, 50/60Hz <input type="checkbox"/> AC240V, 50Hz	Packing size	Main body: 1550×795×955 mm Armrest: 1230×420×760 mm Legrest & footrest: 585×570×615 mm (L×W×H)
Safety design	Class I		



+1 (505) 373-3673
office@rebalanse.com
www.rebalanse.com

